



Monogram

Four Star Plastik®

Monogram Models, Inc., Chicago 32, Ill.

Plastikit PA32.

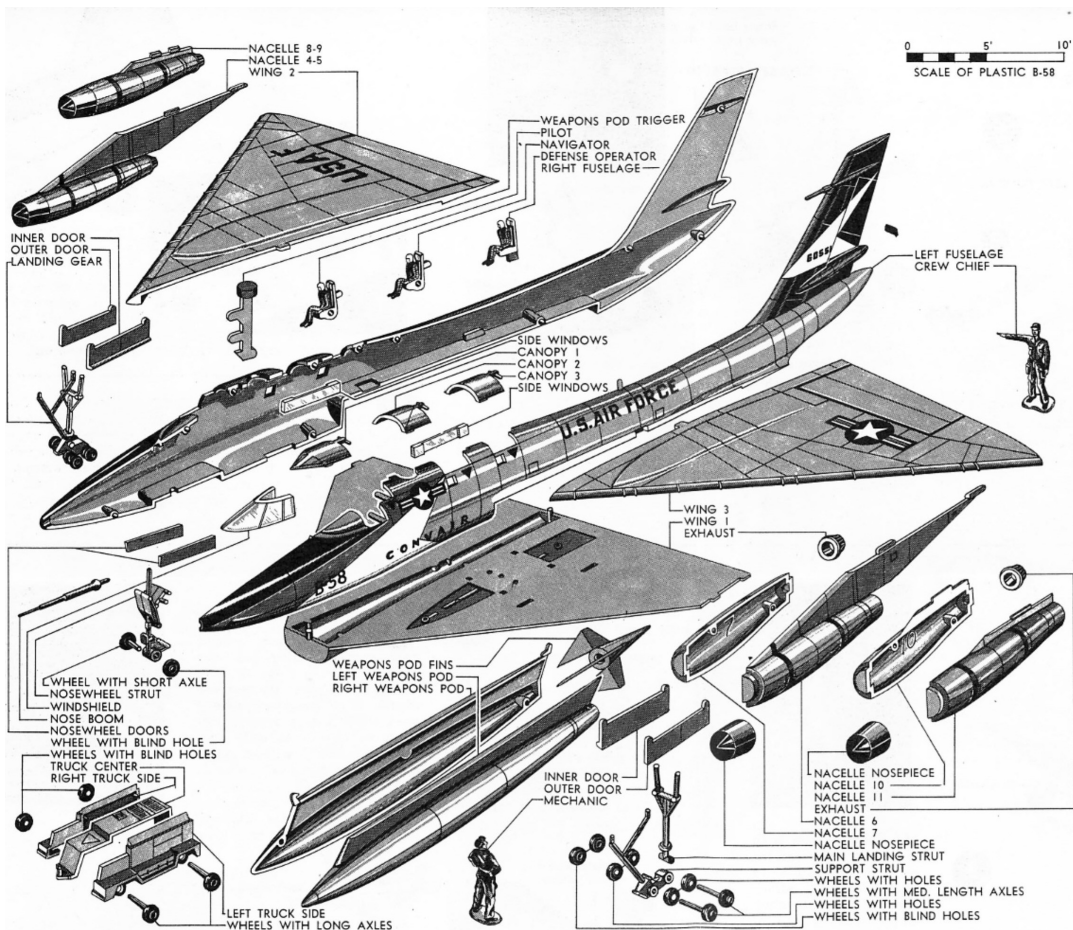

B-58 Hustler

The Hustler is the Air Force's newest long range bomber, capable of carrying a nuclear bomb to targets all over the world. A big aircraft, it spans 57 feet with an overall length of 97 feet. Outstanding characteristics of the B-58 are the four huge jet engines slung under the "Delta" wing and the droppable "Weapons Pod" carried under the fuselage. The plane was designed around the pod which carries a complete weapons system consisting of an Air to Surface Missile System, an Electronic Countermeasures System or a Bombing System which includes a nuclear bomb.

Powered by four General Electric J-79 engines, its speed approaches Mach 2 at operational altitudes above 50,000 feet. Its crew of three includes the pilot, weapons system operator and navigator, seated in tandem in three separate cockpits.

Your Monogram model of the Hustler was designed from blueprints and photographs supplied by the Convair Division of General Electronics Corp., and the U. S. Air Force. Every detail has been carefully reproduced including the weapons pod, which can be dropped by pushing the button on top of the fuselage.

Your kit also includes figures of the crew, two ground crewmen and the portable gas turbine truck used to start the jet engines.

BEFORE YOU BEGIN ASSEMBLY

Study the exploded drawing and the assembly steps to become familiar with all parts of the model. Remove all plastic parts from the "trees" to which they are attached and carefully trim away any excess bits of plastic with a sharp knife, such as an X-acto knife, available at your hobby counter. Check the fit of each part before you cement it in place.

If you are going to paint the details on your model, refer to the paragraph, "Finishing Your Model" on the last page of instructions. Many parts are easier to paint before assembly.

For Best Results

Plastikit Cement. Recommended for use with Monogram Plastikits and all other Styrene plastics. Clear, quick drying. Red, White and Blue tube, 10c.



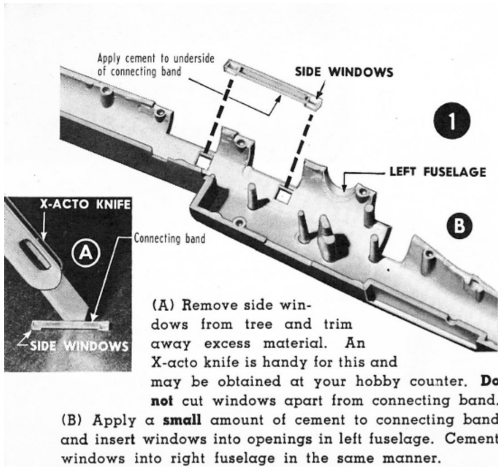

1 Apply cement to underside of connecting band and insert windows into openings in left fuselage. Cement windows into right fuselage in the same manner.

(A) Remove side windows from tree and trim away excess material. An X-acto knife is handy for this and may be obtained at your hobby counter. Do not cut windows apart from connecting band.

(B) Apply a small amount of cement to connecting band and insert windows into openings in left fuselage. Cement windows into right fuselage in the same manner.

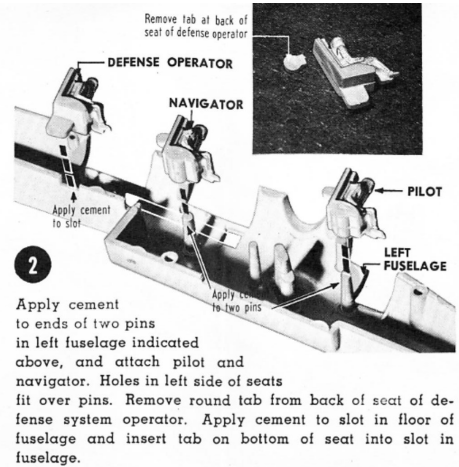

2 Apply cement to ends of two pins in left fuselage indicated above, and attach pilot and navigator. Holes in left side of seats fit over pins. Remove round tab from back of seat of defense operator. Apply cement to slot in floor of fuselage and insert tab on bottom of seat into slot in fuselage.

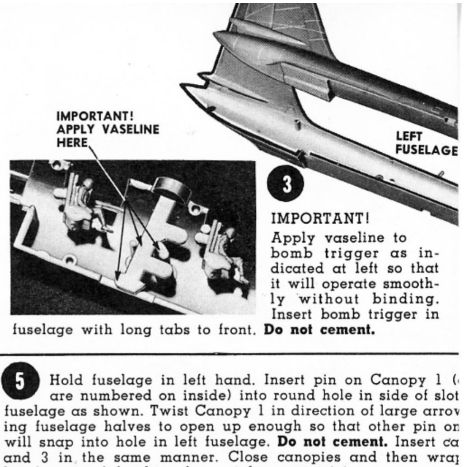

3 IMPORTANT! Apply vaseline to bomb trigger as indicated at left so that it will operate smoothly without binding. Insert bomb trigger in fuselage with long tabs to front. Do not cement.

5 Hold fuselage in left hand. Insert pin on Canopy 1 (are numbered on inside) into round hole in side of slot fuselage as shown. Twist Canopy 1 in direction of large arrowing fuselage halves to open up enough so that other pin will snap into hole in left fuselage. Do not cement. Insert canopies 2 and 3 in the same manner. Close canopies and then wrap bands around fuselage for a tight cement joint.

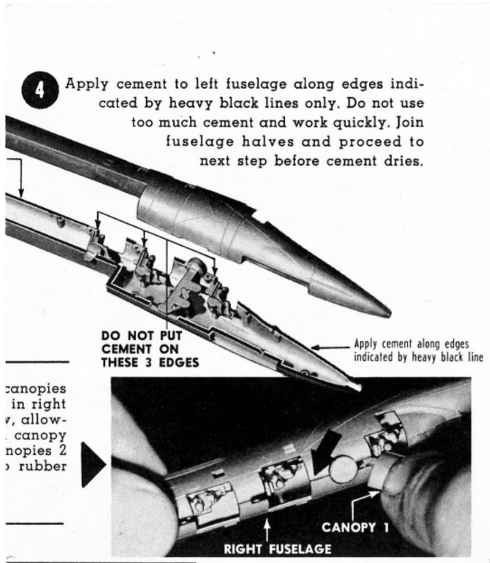

4 Apply cement to left fuselage along edges indicated by heavy black lines only. Do not use too much cement and work quickly. Join fuselage halves and proceed to next step before cement dries.

DO NOT PUT CEMENT ON THESE 3 EDGES

Apply cement along edges indicated by heavy black line

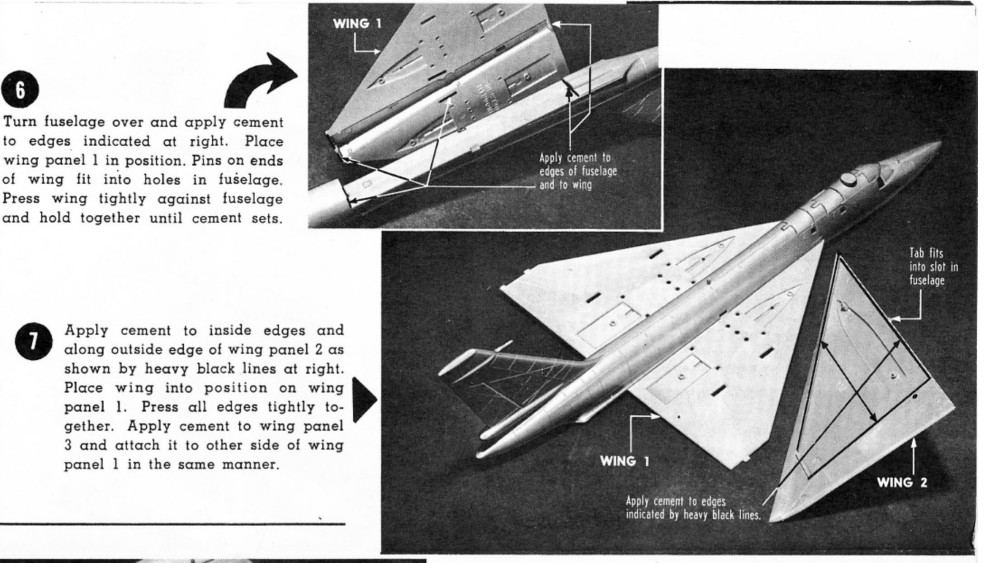

6 Turn fuselage over and apply cement to edges indicated at right. Place wing panel 1 in position. Pins on ends of wing fit into holes in fuselage. Press wing tightly against fuselage and hold together until cement sets.

7 Apply cement to inside edges and along outside edge of wing panel 2 as shown by heavy black lines at right. Place wing into position on wing panel 1. Press all edges tightly together. Apply cement to wing panel 3 and attach it to other side of wing panel 1 in the same manner.

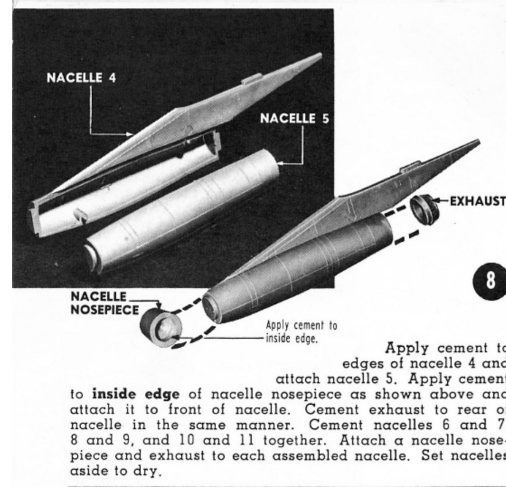

8 Apply cement to edges of nacelle 4 and attach nacelle 5. Apply cement to inside edge of nacelle nosepiece as shown above and attach it to front of nacelle. Cement exhaust to rear of nacelle in the same manner. Cement nacelles 6 and 7, 8 and 9, and 10 and 11 together. Attach a nacelle nosepiece and exhaust to each assembled nacelle. Set nacelles aside to dry.

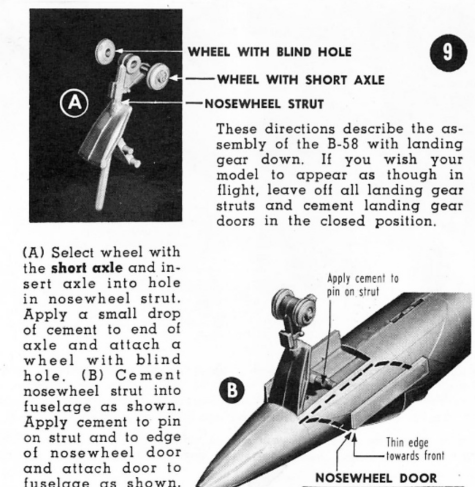

9 (A) Select wheel with the short axle and insert axle into hole in nosewheel strut. Apply a small drop of cement to end of axle and attach a wheel with blind hole. (B) Cement nosewheel strut into fuselage as shown. Apply cement to pin on strut and to edge of nosewheel door and attach door to fuselage as shown.

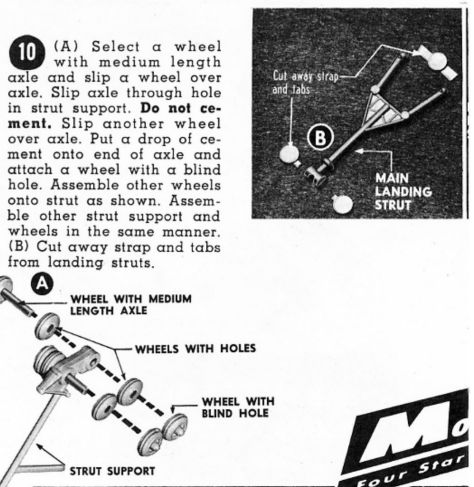

10 (A) Select a wheel with medium length axle and slip a wheel over axle. Slip axle through hole in strut support. Do not cement. Slip another wheel over axle. Put a drop of cement onto end of axle and attach a wheel with a blind hole. Assemble other wheels onto strut as shown. Assemble other strut support and wheels in the same manner. (B) Cut away strap and tabs from landing struts.

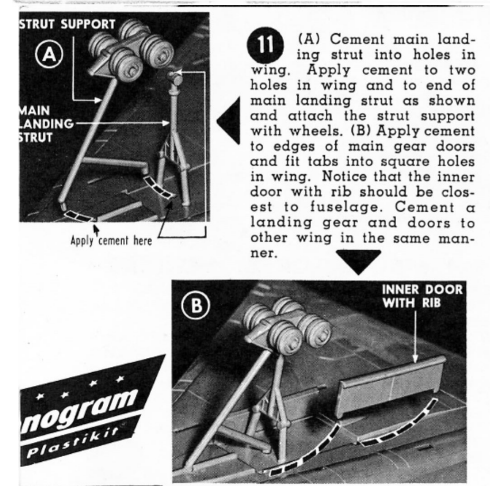

11 (A) Cement main landing strut into holes in wing. Apply cement to two holes in wing and to end of main landing strut as shown and attach the strut support with wheels. (B) Apply cement to edges of main gear doors and fit tabs into square holes in wing. Notice that the inner door with rib should be closest to fuselage. Cement a landing gear and doors to other wing in the same manner.

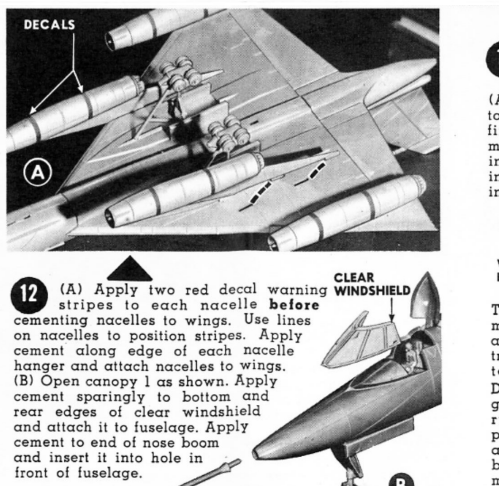

12 (A) Apply two red decal warning stripes to each nacelle before cementing nacelles to wings. Use lines on nacelles to position stripes. Apply cement along edge of each nacelle hanger and attach nacelles to wings. (B) Open canopy 1 as shown. Apply cement sparingly to bottom and rear edges of clear windshield and attach it to fuselage. Apply cement to end of nose boom and insert it into hole in front of fuselage.

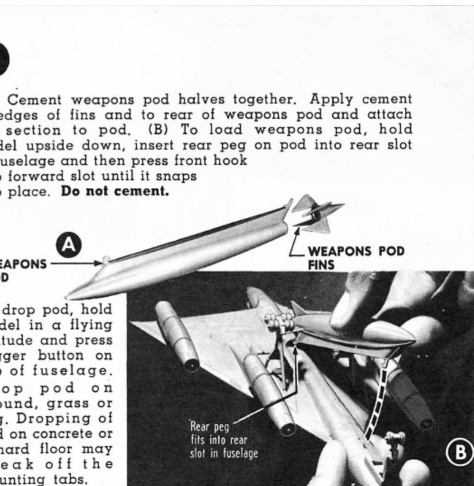

13 (A) Cement weapons pod halves together. Apply cement to edges of fins and to rear of weapons pod and attach fin section to pod. (B) To load weapons pod, hold model upside down, insert rear peg on pod into rear slot in fuselage and then press front hook into forward slot until it snaps into place. Do not cement.

To drop pod, hold model in a flying attitude and press trigger button on top of fuselage. Drop pod on ground, grass or rug. Dropping of pod on concrete or a hard floor may break off the mounting tabs.

